

## Dušas kabīnes montāžas instrukcija

Инструкция по монтажу душевой кабины

Shower enclosure installation assembly

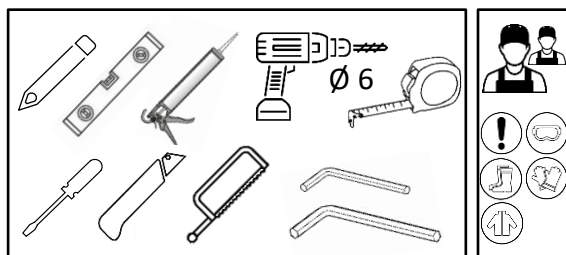

1.		PAL-01	2
2.		PAL-01B	2
3.		NLO-DP01-S001-3	1
4.		MF-42/8-ER	1
5.		SC-SL-UZL90G/G	1
6.		SF67-8-SERE	2
7.		8864-KUO-8	2
8.		2919-8-2SERE	1
9.		S001-PROF-SER	2
10.		S001-SER + SK2SET	2
11.		NFTALL11	2
12.		R50CH-SER	1
13.		3,5X35 SK1SET	2
14.		8 mm Safety Glass	1
15.		8 mm Safety Glass	1
16.		8 mm Safety Glass	1
17.		8 mm Safety Glass	1

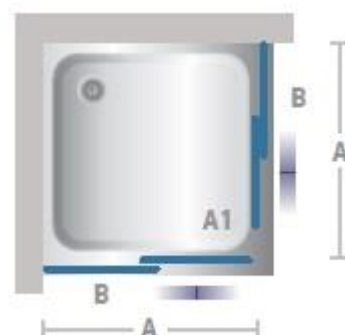
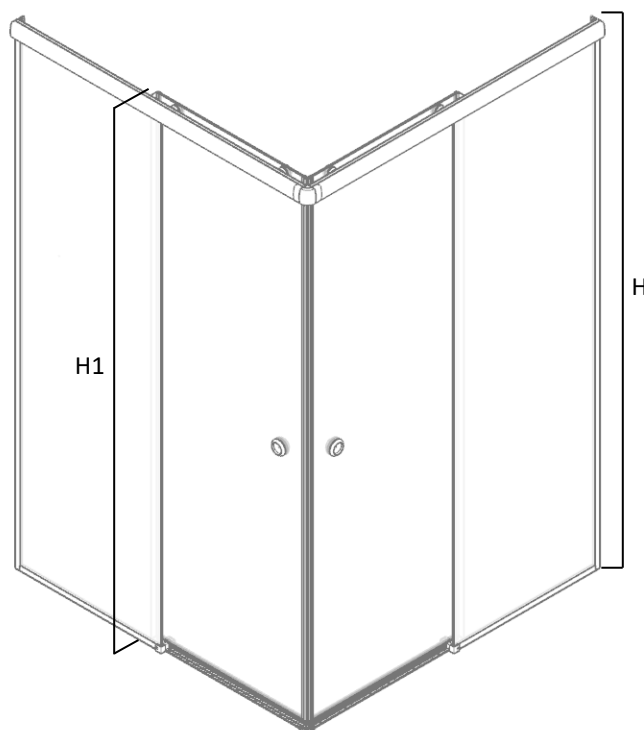

ENISA	A+ B (mm)	A1 (mm)	B (mm)	H (mm)	H1 (mm)
70ENI	680-700	380	370	2000	2005
80ENI	780-800	450	420	2000	2005
90ENI	880-900	520	470	2000	2005
100ENI	980-1000	520	520	2000	2005

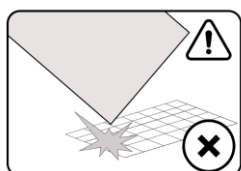
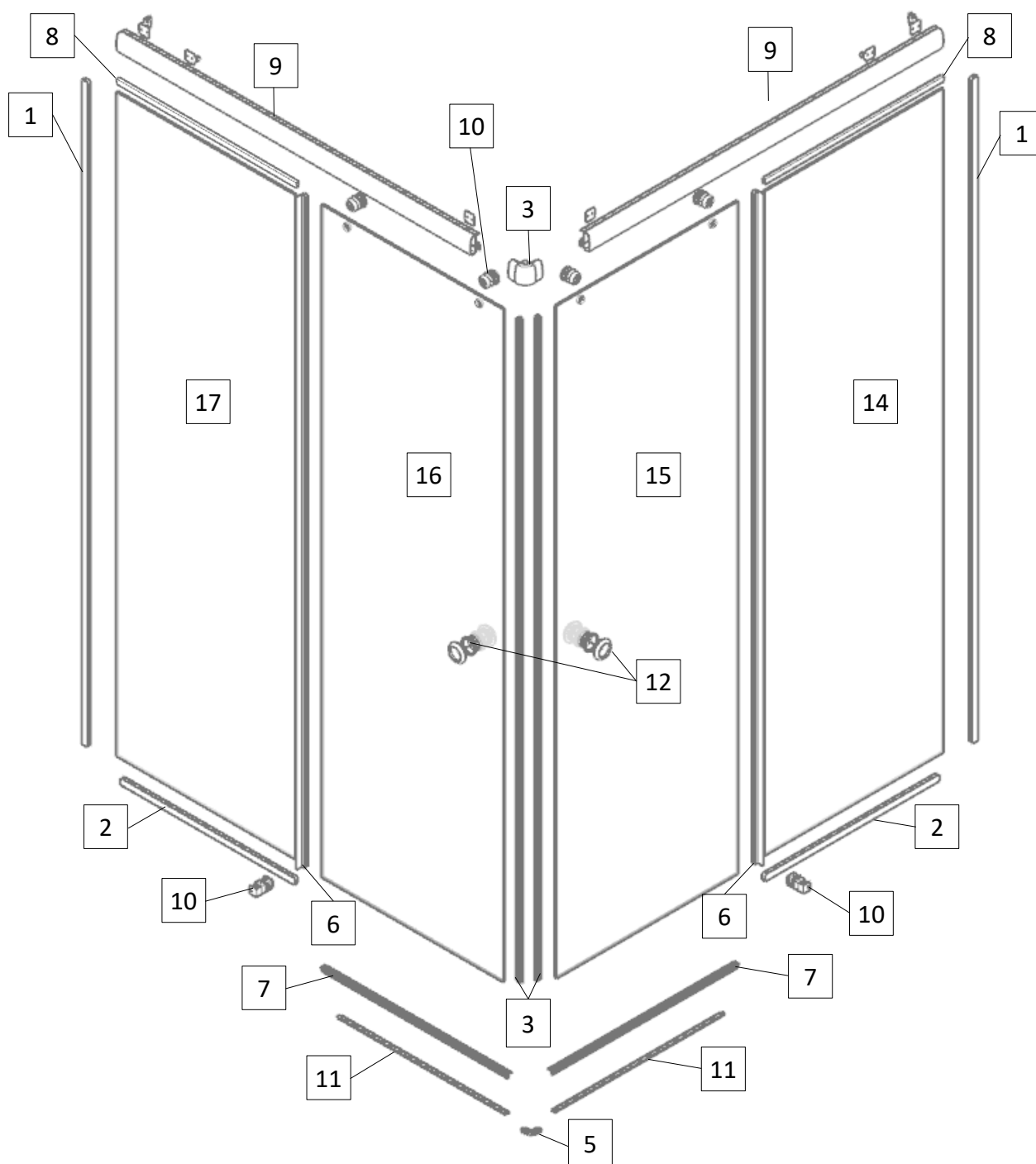

**Uzmanību!** Rūdīts stikls- rīkojieties uzmanīgi. Aizsargājiet stikla stūrus pret triecieniem.

**Внимание!** Закаленное стекло – будьте осторожны. Защищайте углы стекла от ударов.

**Attention!** Tempered glass - proceed with care. Protect the corners of the glass from impact.

# 1.A

ENISA	P, mm	A+B1, mm	C1, mm
70X70ENI	700 x 700	694	694
80X80ENI	800 x 800	794	794
90X90ENI	900 x 900	894	894
100X100ENI	1000 x 1000	994	994

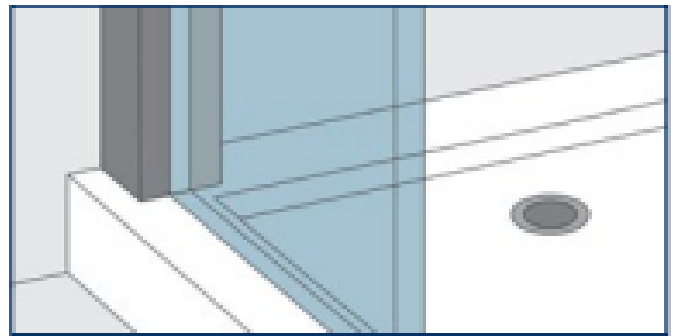
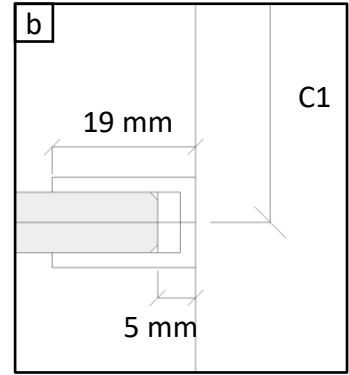
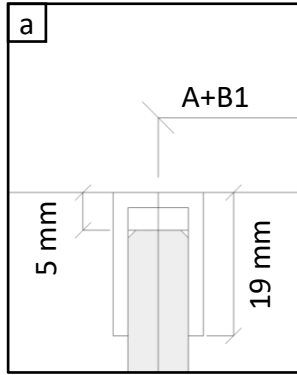
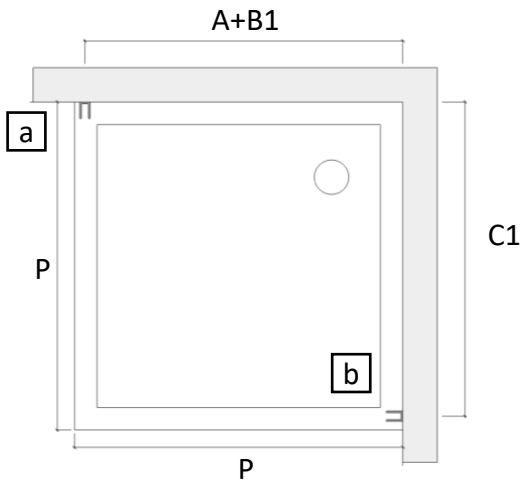

# 1.B

ENISA	D	S
70X70ENI	700	700
80X80ENI	800	800
90X90ENI	900	900
100X100ENI	1000	1000

